



S9 Cradle Universal XXL

EN Installation manual

S9 Cradle Universal XXL

Index

Introductory information	2
1. General	2
2. Security guidelines	2
Installation of the system	4
3. Scope of supply	4
4. Installation of the system	6
5. Installing the S9 Cradle Universal XXL in the vehicle	9
6. Positioning and removing the mobile phone	11
7. Turning the cradle	13
8. Initialising the S9 Cradle Universal XXL	13
9. Charging the phone in the cradle	14
Further information	15
10. Service	15
11. Appropriate use of this system	16
12. Approvals and declaration of conformity	16

1. General

Dear customer,

Congratulations on purchasing a BURY telephone holder for cellular phones. You have chosen a high quality product that is extremely easy to use. Please read the installation manual carefully so that you can fully enjoy your BURY product.

If you have any further questions concerning installation or operation of this device, please contact your dealer. He will be happy to give you reliable advice. You can also contact our hotline. Our phone and fax numbers are listed in the chapter Service.

Have a good trip!

2. Security guidelines

Power supply

The power usage of the cradle has been designed for the use in vehicles with an on-board supply system of 12 volts (passenger car). If you intend to install the device in a vehicle with an on-board supply system of 24 volts (lorry), please use a voltage converter. If you have queries regarding this subject, please contact our hotline.



Position

Install the cradle in the vehicle so that your field of vision is not impaired and the components are not mounted in the impact zone of the passenger compartment or in the airbag inflation zones. Very important: please observe the car manufacturer's information (operating manual) as regards "accessories". If in doubt, please contact a specialist workshop to get information on the correct position for installation in the vehicle.



Intended use

We shall not be liable for damages or malfunctions due to improper use of the hands-free system. Therefore, do not expose the device to moisture, extreme temperatures or shocks and follow the procedure described in the installation manual carefully.



Use while driving

Operate the smartphone in the holder only when the situation allows it and when you do not endanger, harm, constrain, or annoy other road users. The volume of the smartphone has to be set in a way that exterior noise is still audible.

Important:

- ▶ The driver is ultimately responsible for the safe operation and control of their vehicle at all times.
- ▶ Research indicates that there is a risk to safety when the driver of a motor vehicle is distracted and using a mobile phone while driving can be a distraction.
- ▶ The manufacturer strongly recommends that you use a hands-free solution for a phone call when driving.

Faults

Do not use the telephone holder if you detect or assume a defect. In this case, contact a Bury specialised dealer or our hotline. Improper repairs can be dangerous for you. Therefore, only skilled personnel may perform inspections.

3. Scope of supply

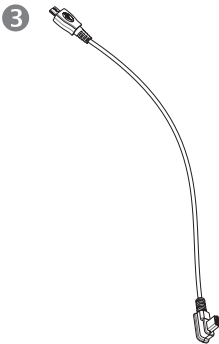
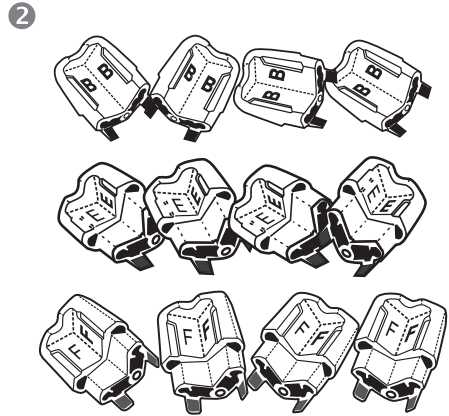
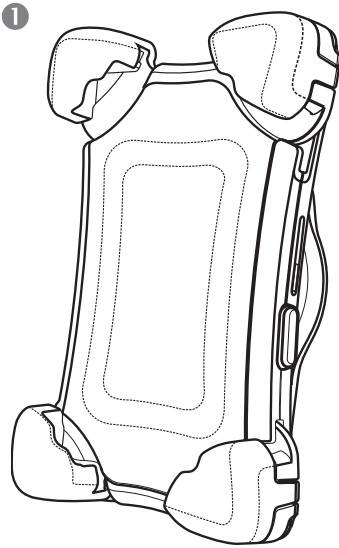

4

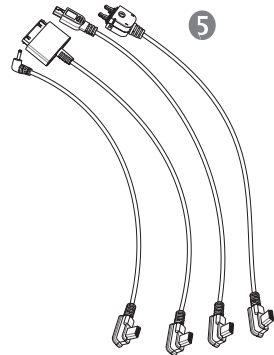

The S9 Cradle Universal XXL is supplied with different combinations of components, depending on the sales regions (countries). The operating manual refers to all versions.

Description of the components:

- 1) Cradle
- 2) Set of tips for specific mobile phone models
- 3) Charging cable (Micro USB)
- 4) Installation manual

Accessories - available separately / including, if applicable:

- 5) Four (different) charging cables (Mini-USB, Nokia Pin 2 mm, iPhone, Sony Ericsson)

Note:

► If certain components are added or omitted you will receive the corresponding information on a separate enclosure.

S9 Base

+

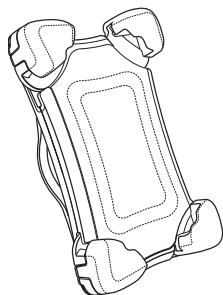
S9 Cradle Universal XXL

+

BURY ChargingCable**Connection options:****1. Power supply**

Connection of the mobile phone's charging cable. The conduction of the power supply occurs via the S9 Base.

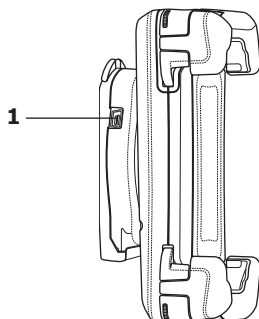

4. Installation of the system

Important:

► When positioning the cradle please take care that the device does not impair the view onto the road, that it will not be installed in the impact zone of the passenger compartment (amongst others in the airbag inflation zones) and that the cable may be laid without any problems.

► Please avoid direct sunlight on the device or high internal temperatures, which can be rapidly reached in parked vehicles. In such cases, remove the cradle and put it in the car glove pocket or glove box for instance.

Step 1:

Adjusting corner fasteners to wide ranging models of mobile phone

To be able to select the suitable type of corner fastener for a certain model of mobile phone / smartphone, please familiarize yourself with the corresponding compatibility list. This list is available on our internet site in the download area for the product at www.bury.com.

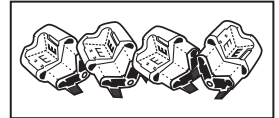

Important:

► Every corner fastener set is equipped with a letter notation which is positioned on the interior side of the corner fastener.

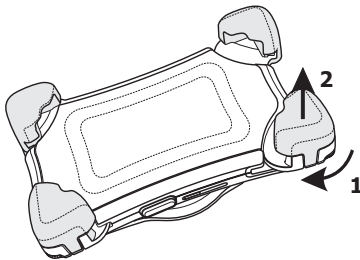
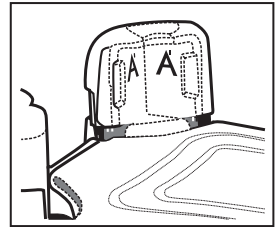

1. Turn the corner fastener with the rotary knob (1) in a clockwise direction.
2. Detach the corner fastener in the direction of the arrow (2).
3. Fit the correct ending for the corner fastener and tighten it by turning it anticlockwise.
4. Repeat the above steps with the remaining three corner fasteners.

Step 2:**Adapting the S9 Cradle Universal XXL to the size of the mobile phone****Important:**

► Before you begin to adjust the cradle to fit your particular mobile phone, it is important that you set the cradle to the closed position. This can be done by pushing the top of the cradle down until the locking button on the right side of the cradle, pops out with an audible "click".

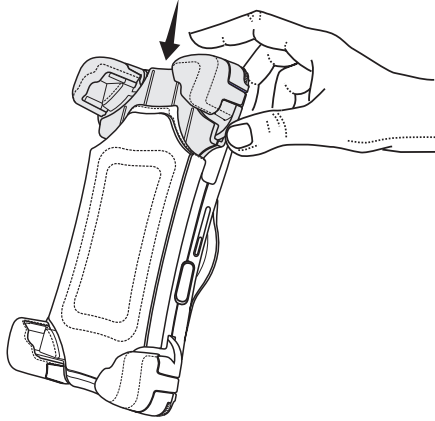

To be able to adapt the cradle to the size of the mobile phone lift all of the adjustment locks by pressing the release buttons **1, 2, 3**.

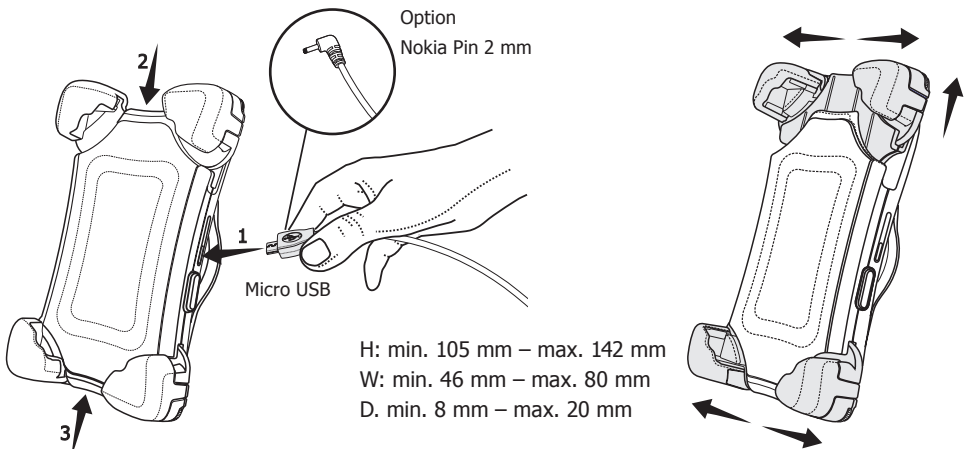

Insert the mobile phone into the cradle.

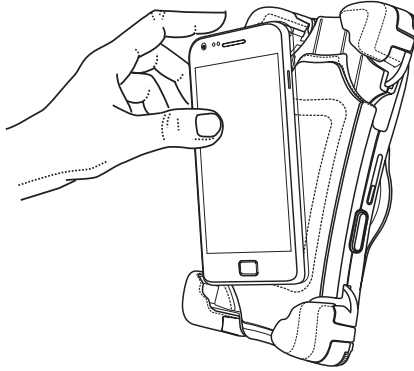

Firstly, adjust the lower width of the cradle to the width of the mobile phone and press button **1** in order to block the set position. Next adjust the height and the upper width of the cradle to the height and width of the phone and press in keys **2** and **3** in order to block the set positions.

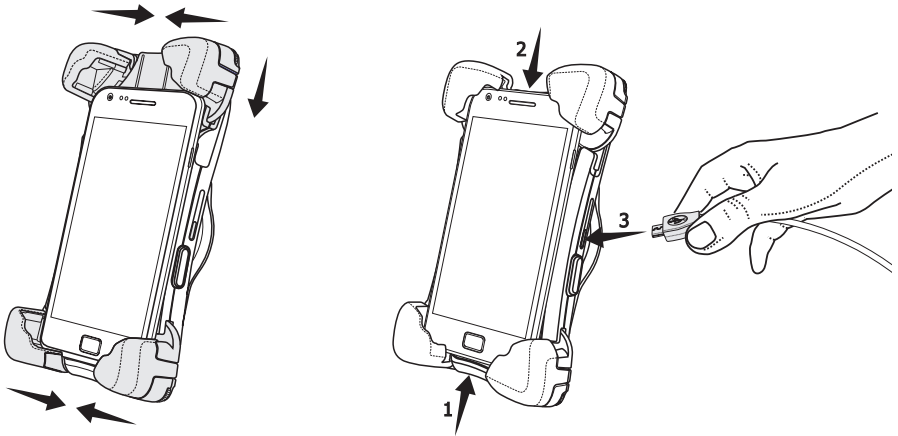

Please note:

► It is possible to set all positions of the cradle at the same time by lightly pressing button **1, 2** or **3**.

Step 3:
Adjusting the corner fastener

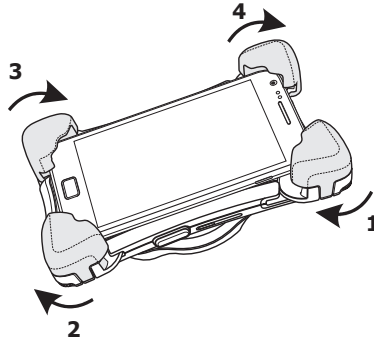

Adjust the corner fastener to the thickness of the phone – increase the depth by turning it in a clockwise direction, tighten it by turning it anticlockwise.

5. Installing the S9 Cradle Universal XXL in the vehicle

Place the S9 Cradle Universal XXL cradle in the S9 Base.

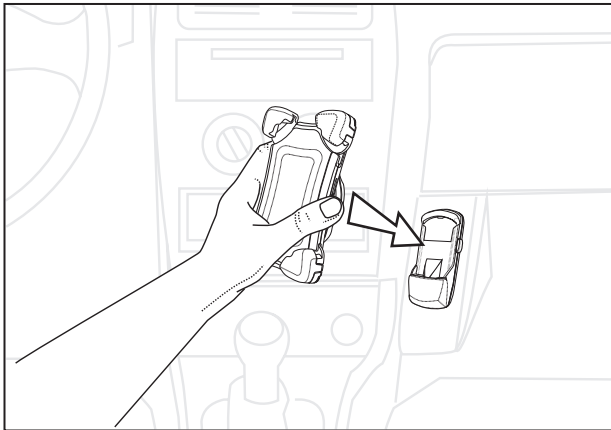

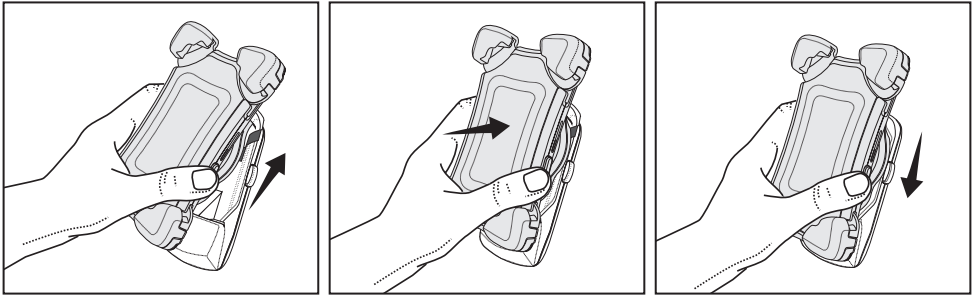
**Important:**

► The correct mounting of the S9 Cradle Universal XXL in the S9 Base is signalled by a perceptible 'clicking' sound.

Removing the S9 Cradle Universal XXL cradle from the S9 Base.**Important:**

► Before you remove the cradle from the S9 Base you will have to remove the blocking mechanism by pressing the locking button on the right hand side of the S9 Base.

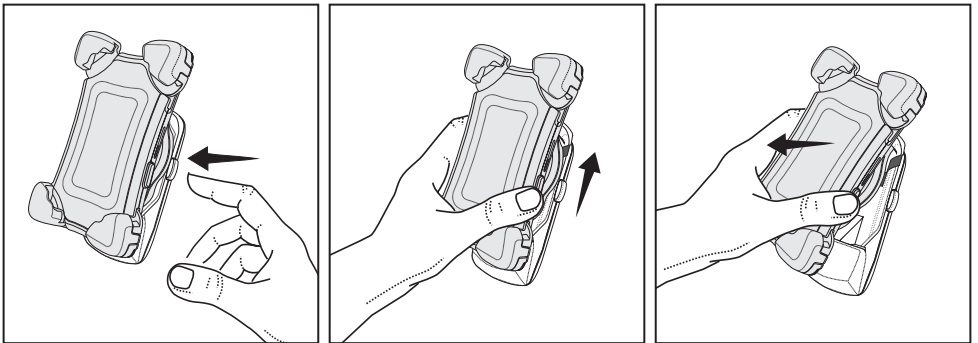

6. Inserting and removing the mobile phone

Insert the smartphone in the S9 Cradle Universal XXL cradle.

Before you insert the smartphone in the cradle, release the holding mechanism by pressing the locking button in. The locking button is situated on the right hand side of the cradle.

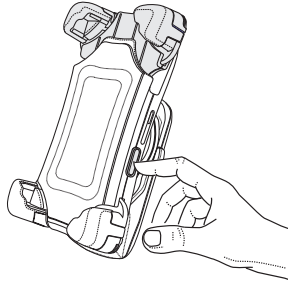

If necessary, remove the protective cover from your smartphone. Place the smartphone in the cradle from above.

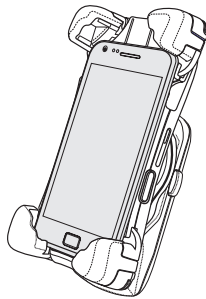

Press the top part of the cradle downwards and you will hear the smartphone click into the cradle. The correct positioning of the smartphone in the cradle is signalled by a perceptible 'clicking' sound.

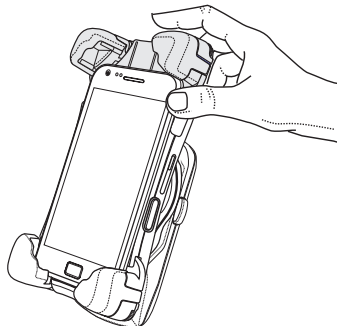

Removing the smartphone from the S9 Cradle Universal XXL cradle.

To release the locking mechanism press the button on the right hand side of the cradle.

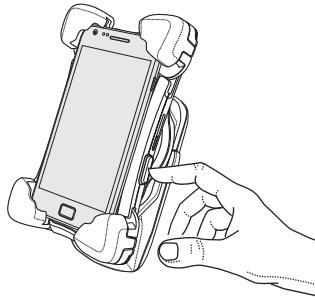

Now remove the smartphone by lifting it out of the cradle.

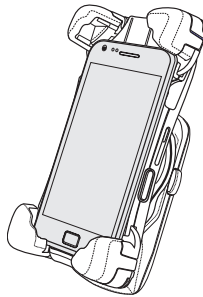

7. Rotating the cradle

You can turn the smartphone by 180 degrees (90 degrees to the left or right accordingly) together with the cradle. Rotate your device to best suite the application you are using. Used in the landscape (horizontal) format, most smartphones will adjust the text size and websites images automatically making them easier to read. Using the cradle to the landscape format also gives more space for the onscreen keyboard making it easier to enter text data.

Important Safety Notice:

► Entering text or viewing websites on your smartphone whilst driving is extremely dangerous and illegal in most countries. Always ensure your vehicle is stationary and safely parked before using your smartphone for these activities. Setting your cradle or phone screen format should be done before commencing your journey.

Navigation applications especially benefit from the landscape format view because all the operational elements of the software are positioned clearly. Due to the reduced horizon in the landscape format, the 3D map presentation will probably contain significantly more detailed information.

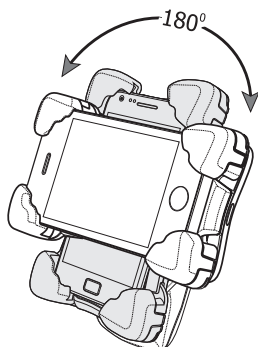

8. Initialising the S9 Cradle Universal XXL

After the power supply of the S9 Base is successfully connected, the S9 Cradle Universal XXL is activated when you have started the vehicle.

The S9 Cradle Universal XXL has an inductive antenna coupling. This means that the functioning of the integrated antenna in the corresponding smartphone is transferred to an external antenna. This also means that a GSM antenna must be connected to the BasePlate of the hands-free car kit which is being used, otherwise the send-receive performance will be restricted.

9. Charging the phone in the cradle

If a corresponding cable is connected to the telephone, the smartphone that is positioned in the S9 Cradle Universal XXL will be supplied with electrical power (please refer to the picture). The conduction of the electricity supply occurs from the S9 Base.

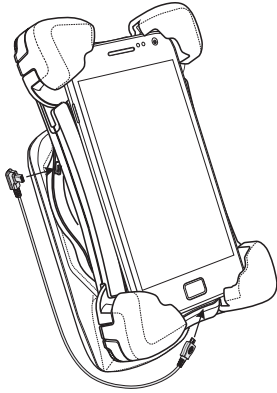

10. Service

In case of general or technical queries, suggestions and comments, please do not hesitate to contact our team at any time. Suggestions and feedback are always welcomed:

Administration:

BURY GmbH & Co. KG
Robert-Koch-Straße 1-7
D-32584 Löhne
Germany

Producer:

BURY Spółka z o.o.
ul. Wojska Polskiego 4
39-300 Mielec
Poland

Hotline Tel.: +49(0)180 6 - 842 468*

* 0.20 €/min. Deutsche Telekom AG landline. The costs of international telephone calls which are made from abroad can vary.

E-Mail: hotline@bury.com

Warranty / Service desk:

The duration of the warranty for the components of this product totals two years subsequent to the date of sale to the end customer. Any warranty claims you may have as an end customer are to be asserted towards your contractual partner. If the corresponding contractual partner is not able to rectify a corresponding fault, please exercise your rights of purchase. If subsequent to agreement with your contractual partner the product is to be sent directly to the manufacturer, then please send it, along with a detailed description of the fault in the German or English language and a copy of the proof of purchase, directly to our service team:

BURY GmbH & Co. KG

Im Hause DPD Depot 103
Robinienweg
D-03222 Lübbenau
Germany

Specific explanations regarding the assertion of claims based on defects of the product (warranty / guarantee / service) for certain countries can be found at the end of these instructions.

Information on the disposal of electrical goods in the EU

The crossed out wheellie bin symbol means that electrical and electronic products, batteries and accumulators must be disposed of separately in the European Union. Please do not dispose of any such products in your normal household waste. As the owner of a product of this sort you are legally obliged to dispose of it at your local dumping site or recycling centre, where you are able to leave your waste electrical goods free of charge.

11. Appropriate use of this system

The S9 Cradle Universal XXL is only intended for use in motor vehicles. When using this system, please comply with the regulations and laws specific to the country in which you are driving and the instructions provided in the guidebook for the mobile telephone that you are using.

12. Approvals and declaration of conformity

At BURY, purchase, production, as well as distribution and service, follow environmentally friendly processes according to the ISO 14001 Standard and Quality Management Requirements, according to the ISO/TS 16949 Standard. The device has



the CE approval pursuant to the R&TTE 1999/5/EC regulation

You can request a conformity declaration from the manufacturer of this product by post under the manufacturer's address which is stated above, or by writing to the following email address: ce_conformance@bury.com

Version: 04/2015

25.1652.0-02-100415

Errors and omissions excepted.

© 2015 by BURY. All rights reserved.

EXPRESS WARRANTY AGAINST DEFECTS – AUSTRALIA:

This product if imported by Point to Point Distributions Pty Ltd is warranted in Australia to be free from any defect in material and workmanship, subject to the following terms and conditions.

Who provides this warranty: Point to Point Distributions Pty Ltd
Unit 9, 7-8 Len Thomas Place Narre Warren Vic, 3805.
Tel: +61 3 8794 1800
Email: service@ptpdist.net.au

Geographical Region: PRODUCTS PURCHASED IN AUSTRALIA
imported by Point to Point Distributions Pty Ltd.

Warranty Period: 2 YEARS FROM DATE OF PURCHASE
(please retain your receipt as your proof of purchase will be required to valid warranty claim)

WARRANTY CLAIM PROCESS:

In the unfortunate event of a failure of your product, please contact Point to Point Distributions via our email address or phone:

Tel: +61 3 8794 1800

EMAIL: service@ptpdist.com.au.

PTP will ask you to provide evidence of your purchase receipt, to establish the warranty claim is within the 2 year warranty period. Failure to provide your purchase receipt will result in PTP rejecting your warranty claim.

PTP offers an advance replacement of your faulty product. Please note our replacement units are a like-for-like product, and may be refurbished units that are of the exact same model and version. Goods presented for repair may be replaced by refurbished goods of the same type rather than being repaired.

Refurbished parts may be used to repair the goods. Upon validation of your warranty claim, PTP will send your replacement unit, freight paid and include a pre-paid return bag for the return of the faulty product. If you choose do not wish to proceed with the warranty claim, you must return the replacement unit to us using the pre-paid return bag. Failure by the customer to return either unit within 14 days may incur a charge for the cost of the replacement unit.

WARRANTY EXCLUSIONS.

Failure to provide a proof of purchase will result in your warranty claim being rejected.

Product failure due to customer misuse, abuse or abnormal use, failure by the customer to take reasonable care, failure sure to not using the product in accordance with instructions stated in the manufacturers user guide.

Product failure due to recommended installation procedures not being followed as stated in the manufacturers guide.

YOUR RIGHTS UNDER THE AUSTRALIAN CONSUMER LAW

Our goods come with guarantees that cannot be excluded under the Australian Consumer Law.

You are entitled to a replacement or refund for a major failure and for compensation for any other reasonable foreseeable loss or damage. You are entitled to have goods repaired or replaced if the goods fail to be of acceptable quality and the failure does not amount to a major failure.